

Company Profile



Connecting Solutions

Our complete range of Fluid Connectors is a state of art program of port to port hydraulic solutions including hydraulic fittings, hydraulic hoses, OEM hose assemblies, hydraulic adaptors and tube fittings, quick disconnect couplings and swivel joints.



Fully compatible Hose & Fittings range

Fully compatible hydraulic hose and fittings system available in different styles and terminations*. Hose range from 1/8" one wire braid to 3" 6-spiral. Couplings are available in both two piece and one-piece styles; the assembling can be done with both external/internal skiving or as total no skive.

** Assembled products correctly to Intertraco specifications*

Fully approved applications

All hose and fittings combinations are extensively tested, and their validation is certified by DNV, ABS, USCG.



Exceeding the standards

Our products are designed with advanced FEM methodologies targeting performances exceeding the most severe international and industry standards. All project data are tested and validated in our laboratories by our R&D team.

From design to delivery:

01 Fem design / 02 Impulse test / 03 Advanced manufacturing
04 Individual inspection / 05 Laboratory test / 06 Advanced logistics

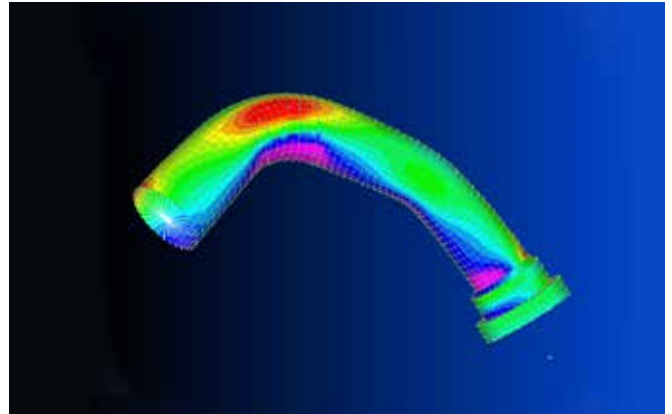

01 ▲



02 ▲



03 ▲



04 ▲



05 ▲



06 ▲

State of Art Manufacturing

Our modern and automated manufacturing processes are implemented according to the most advanced industry 4.0 best practices and are supported by strict quality control procedures allowing the complete traceability of products at all stages of their life cycle.

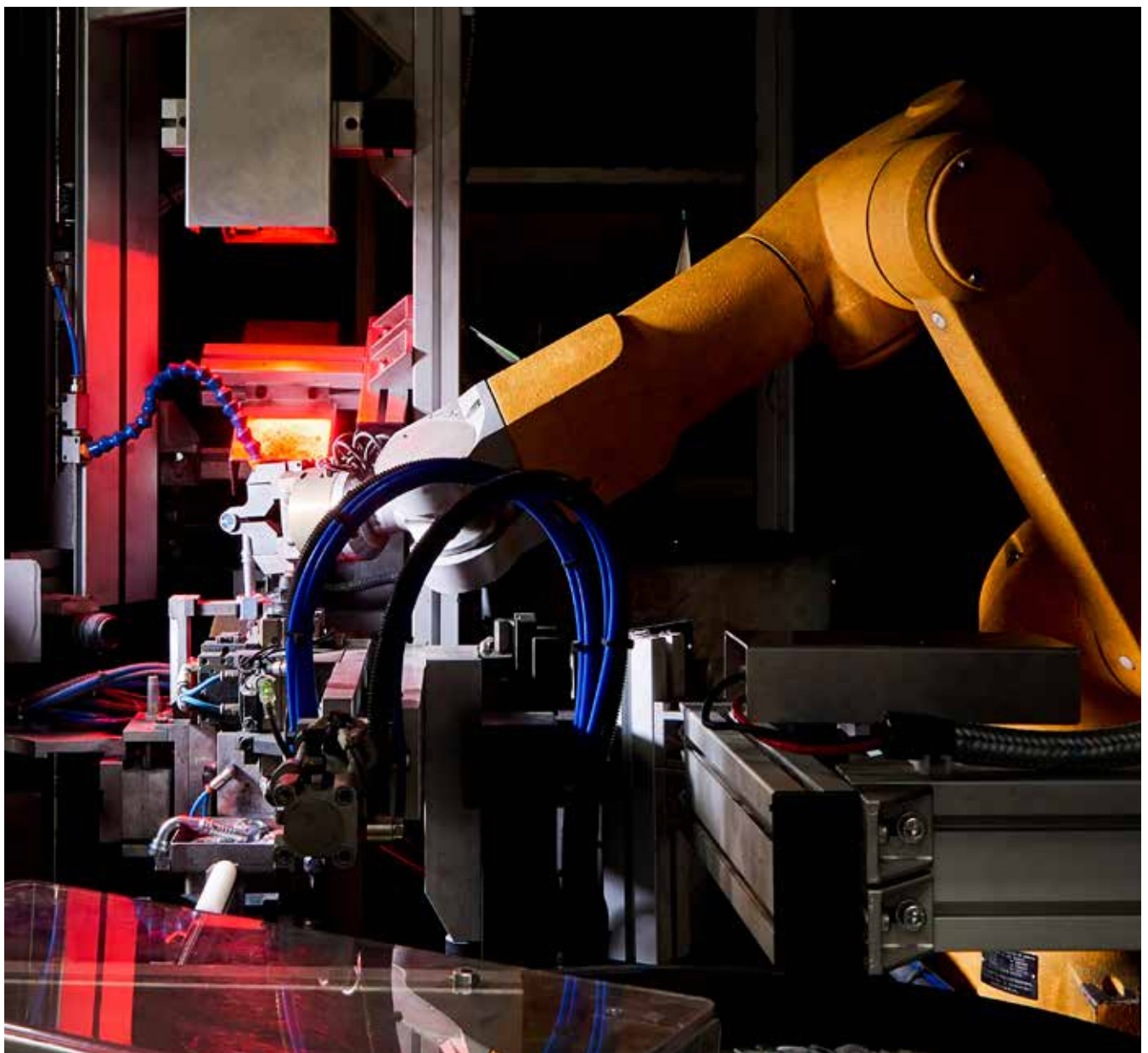



Two Piece Fittings



One Piece Fittings



Bridgestone Hose Range



Intertraco Hose Range



Adaptors



Hose Assemblies



Quick Couplings

Intertraco (Italia) S.p.A.

Via Amaldi 1/A
I-46029 Suzzara
Mantova | Italy

T +39 0376 539711
F +39 0376 521722
info@intertraco.it

www.intertraco.it

